

## HOUSING INFORMATION FOR AFFILIATE SCHOLAR PROGRAM

The East-West Center has three residence halls: Hale Manoa, Hale Kuahine, and Lincoln Hall. Hale Manoa and Hale Kuahine are dormitories that generally house the Center's long term residents including students and interns. Lincoln Hall apartments provide shorter term accommodations for visiting fellows, conference and workshop participants, and visitors. Participants in the Affiliate Scholar Program are normally accommodated in single rooms in Hale Manoa and Hale Kuahine.

Hale Manoa is a 13-story building serviced by two elevators. Certain sections (floors) are designated for men or women only. Other sections are coeducational, and married couples may be accommodated in double rooms. Rooms are arranged into living units, with each unit consisting of three double and four single rooms. Each living unit has shared bathroom/toilet facilities and storage area. Communal kitchen facilities and coin-operated laundry machines are located on each floor. Other amenities include individual mailboxes, daily newspapers in the common area, snack/beverage vending machines, and ice machines. In addition, residents have access to lounges for TV viewing, small meetings, or social functions.

Hale Kuahine is a four-story building with no elevator. Physical arrangements are similar to Hale Manoa, and each living unit has shared bathroom facilities. The communal kitchen facilities, lounge, and laundry machines, and reception desk are located on the ground floor.

Most residents of the dormitories are graduate students and the average age of residents is over 30 years. As the residents are generally representative of the East-West Center community as a whole, the population is international. Unlike typical U.S. university dormitories, Hale Manoa and Hale Kuahine remain open throughout the year, and Hale Manoa accommodates people arriving and departing daily.

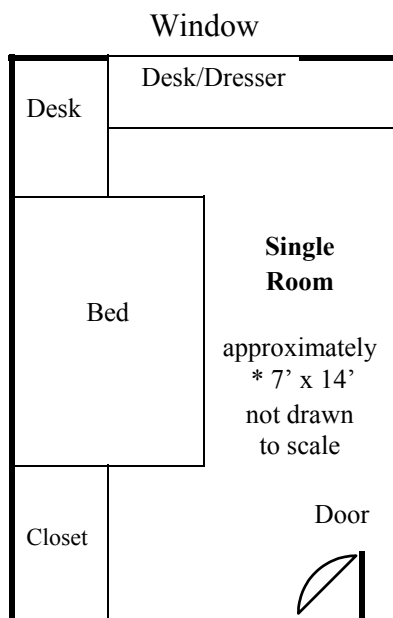

### Room Furnishings and Services

Rooms contain a desk, dresser, chair, bed, study lamp, telephone, clock radio, fan, and closet space. Linen and bedding (including pillow, blanket, bedspread, two sheets, and a pillow slip) are provided. Soiled linen may be exchanged for fresh linen at the reception desk. Towels are not provided but may be purchased from the desk.

The Hale Manoa reception desk is staffed 24 hours a day and provides check-in and check-out services. The desk also takes messages, provides change for laundry and vending machines, issues spare keys, and provides general information. The Hale Kuahine desk provides similar services, but has limited hours.

\* 7' x 14' = 2.134m x 4.267m  
\* 98 ft<sup>2</sup> = 9.104 m<sup>2</sup>

Additional information about housing may be obtained by writing to [affiliates@eastwestcenter.org](mailto:affiliates@eastwestcenter.org)