

Spring 2009

Housing contracts are extended on a semester basis with proof of current affiliation. Unless otherwise noted, the check-out date will be
05/19/09

Housing Rates*

	Daily Rate (Less than 30 Nights)	Monthly Rate (30 - 89 Nights)	Semester Rate (More than 90 Nights)
Single Room	\$27	\$19	\$17
Double Room **	\$37	\$29	\$25

* Rates will be adjusted upward/downward based on one's continuous length of stay

** Single or double occupancy. (For double occupancy, both individuals must meet application requirements.)

For further information, please refer to our *Frequently Asked Questions* at:
<http://www.eastwestcenter.org/about-ewc/housing/frequently-asked-questions/>

Single Room Floor Plan

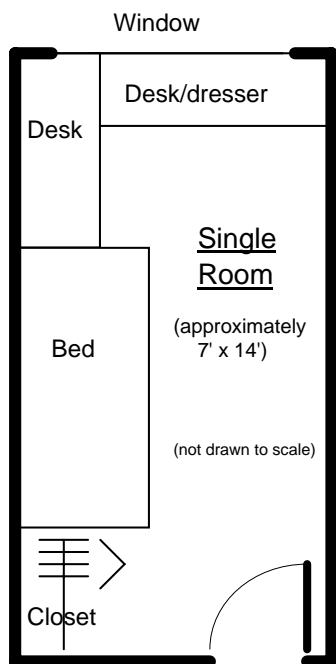

Linen and bedding (including pillow, blanket, bedspread, two sheets and a pillow slip) are provided. Double rooms are twice the size of single rooms with furnishings for two persons.

Rev: 1/09

Application must include:

- Non refundable application fee of \$20 (check made payable to the East-West Center)
- Completed Housing Application/Contract form
- Departmental letter verifying graduate status or affiliation
- EWC health clearance form (to be submitted within two weeks of check-in)
- Housing Statement

Mailing Address:

East-West Center
Housing Office
1711 East-West Road
Honolulu, HI 96848-1711

Housing Information: (808) 944-7805
FAX (808) 944-7790
Email: housing@eastwestcenter.org